

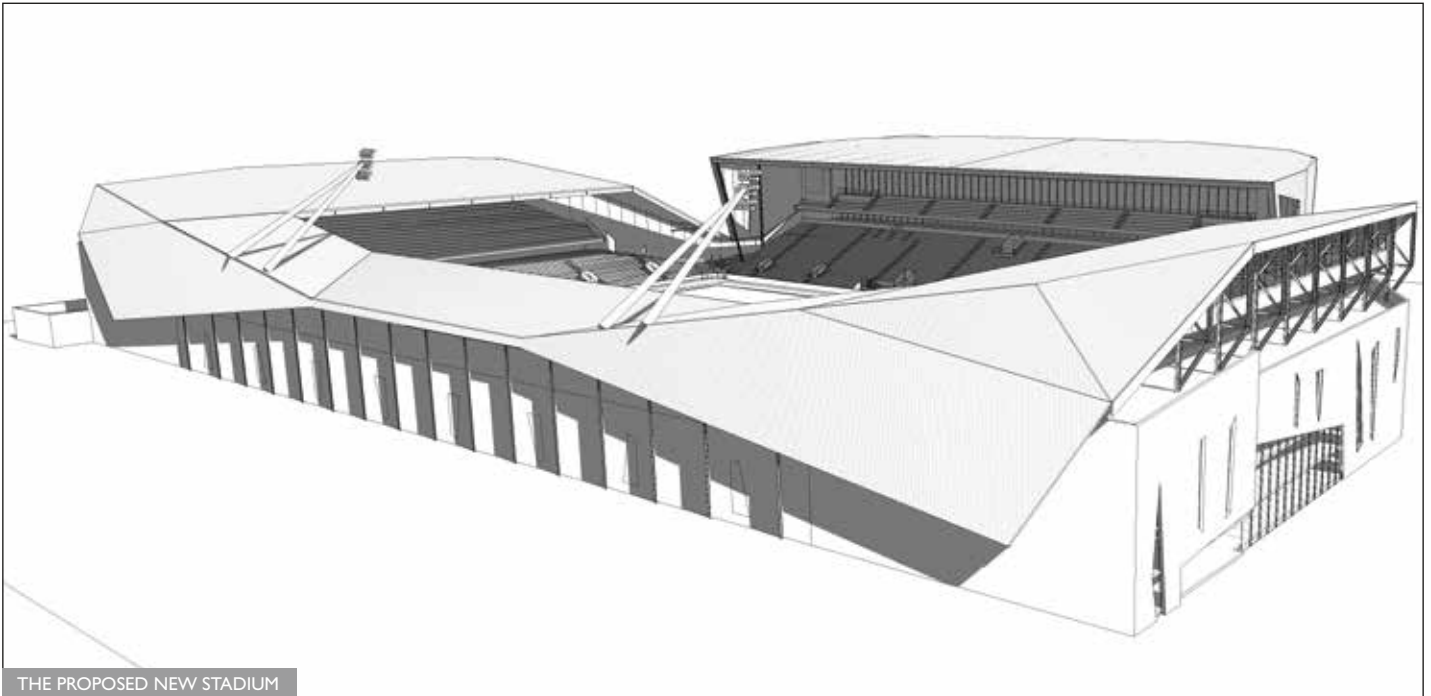

BRENTFORD COMMUNITY STADIUM

More than just a football club

NEWSLETTER 2 | MARCH 2013



THE PROPOSED NEW STADIUM

Dear Neighbour,

Welcome to the second community newsletter for the proposals to relocate Brentford Football Club.

In January of this year we presented the initial proposals for the redevelopment of the Lionel Road South site at a public consultation exhibition. Held over three days the exhibition was attended by over 300 people and was the first step in consulting local residents on the proposals.

Since this point we have continued to meet with local groups in the community and are now ready to present further details of the scheme to you.

The project vision is to:

- provide a modern high quality 20,000 seat stadium for first class, professional football and rugby with income growth potential in order to secure the long term sustainability of Brentford Football Club;
- provide a social focal point with a buzz of activity;
- enable the Brentford FC Community Sports Trust to provide a range of activities that will:
 - attract all age groups from all sections of the local communities;
 - promote sport, health, education, employment and training, social enterprise and social inclusion;
- assist in the regeneration of the area and build close links with local businesses and residents

The Club is developing a bold and imaginative scheme to build a stadium complemented by residential enabling development to generate funding and act as a catalyst for the wider regeneration of this area and create an attractive link from the river Thames to Gunnersbury Park.

Further details of the exhibition location and times are overleaf. We hope that you are able to attend, but if this is not possible please feel free to contact a member of the development team if you have any questions.

Yours sincerely,

Brian Burgess

Director, Lionel Road Developments Limited

DID YOU KNOW?

The new stadium will also provide a new home for Brentford FC Community Sports Trust, the club's charitable arm which works with over 27,000 young people and also runs the Griffin Park Learning Zone and the Brentford Boating Arch at nearby Kew Bridge.

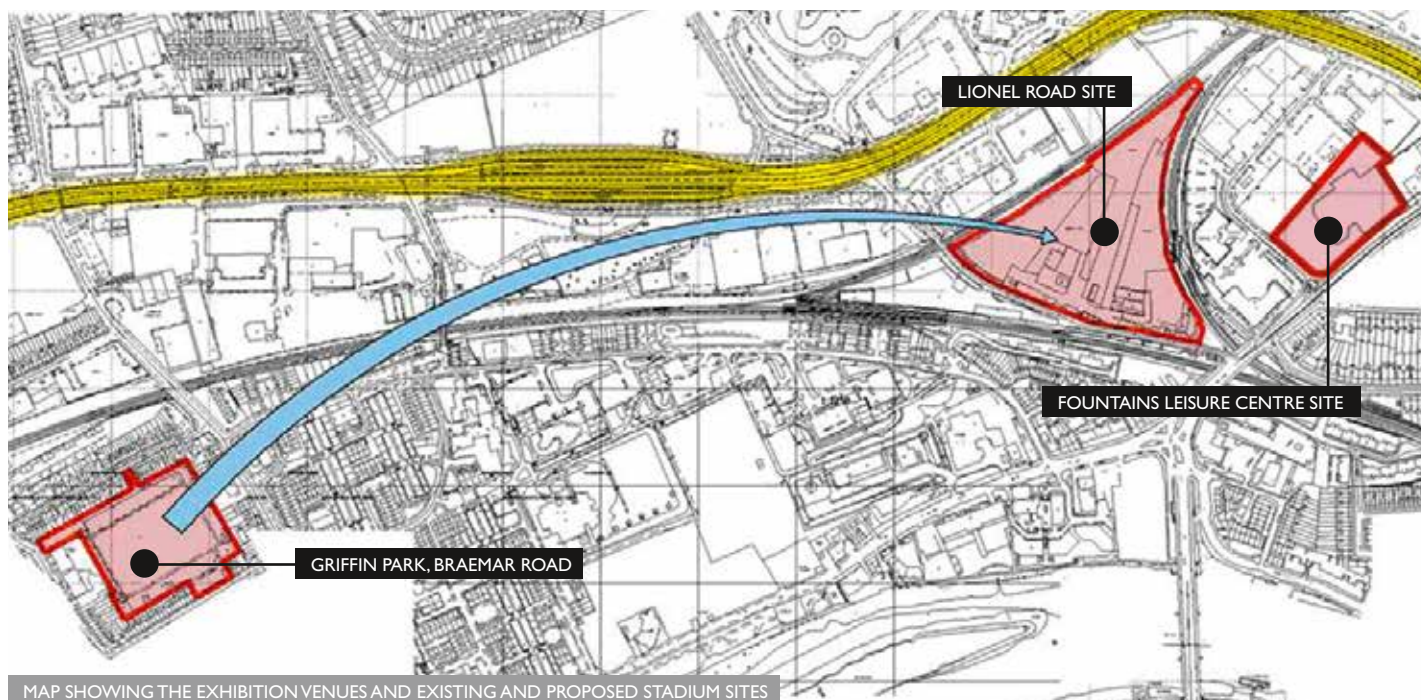

MAP SHOWING THE EXHIBITION VENUES AND EXISTING AND PROPOSED STADIUM SITES

OUR EXHIBITION

Your views matter a great deal to us. Our exhibition is taking place over three days in March 2013:

Dates Thursday 21st March: 5:30pm - 8:30pm

Friday 22nd March: 1pm-5pm

Venue Griffin Park, Braemar Road Entrance

Date Saturday 23rd March: 10am – 1pm

Venue Brentford Fountain Leisure Centre, Sports Hall

CONTACT US

Even if you cannot make the exhibition we would still like to hear from you.

You can write to us at our FREEPOST address:

Brentford Community Stadium
FREEPOST RLSX-KHXT-BGSR

C/o Four Communications
The Communications Building
48 Leicester Square
London, WC2H 7FG

T: Nicholas Vose on 020 3023 9081

E: nicholas.vose@fourcommunications.com

www.brentfordcommunitystadium.com



PROPOSED SITE PLAN